



18 Guildford Street
, Hereford, Herefordshire, HR4 0DS

jackson
property

£220,000

Attractive 2 Bedroom End Terrace Property | Two Bathrooms | Two Double Bedrooms | Two Reception Rooms | Spacious Kitchen | Enclosed Garden | On Street Parking | Walking Distance to City Amenities | Sold with No Onward Chain

Situation

Located in the popular residential area of Whitecross, just half a mile west of the city centre of Hereford. Nearby are excellent local amenities to include local shop, church, public house and primary & secondary schooling, whilst more extensive amenities can be found in the city centre, within walking distance and with regular bus services.

Description

The property benefits from full gas central heating, double glazing and enjoys many period features with the advantage of oak wooden flooring to the majority of the rooms along with neutral decor.

The property is approached from the wooden front door into the well proportioned sitting room with a period feature fireplace and large window to the front. A door leads into the second reception room which provides space for dining table and chairs adjacent to the kitchen. Stairs lead up to the first floor. A double glazed window leads

Law Society - Buyer Information Pack

The Seller of this property has provided a detailed 'Buyer Information Pack' which contains additional information about this property. Please ask us for access to this pack.

Services

All mains services are connected. Herefordshire Council Tax Band B.

What3Words Directions

///focal.paid.early

Viewings

Strictly by appointment. Please contact the agents on 01432 344779.

Viewings to be conducted under our viewings policies, copies of which can be found on www.bill-jackson.co.uk

Jackson Property

for themselves and the vendors of the property, whose agents they are, give notice that these particulars, although believed to be correct, do not constitute any part of an offer of

Referral Fees

Jackson Property may be entitled to commission or fee from other services offered to the Client, buyer, tenant or landlord, including but not only the following services: Conveyancing, Mortgage, Financial advice, Surveys etc. A commission or fee is defined as an average of £100+vat per service.

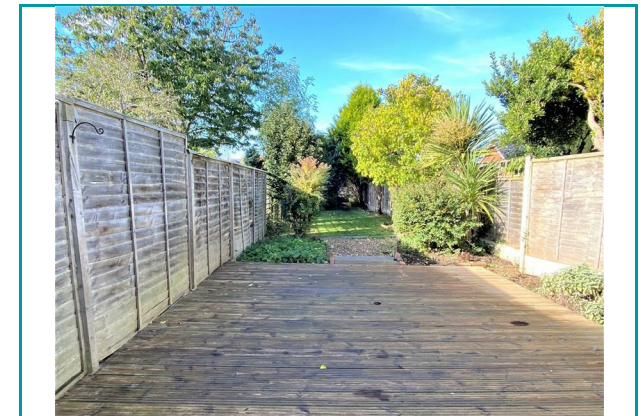

To arrange a viewing please contact us on t. 01432 344 779
hereford@bill-jackson.co.uk | www.bill-jackson.co.uk

Ground Floor

Approx. 43.8 sq. metres (471.0 sq. feet)

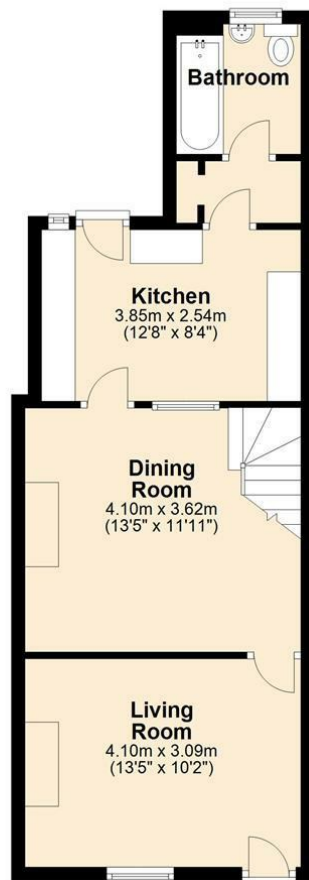

First Floor

Approx. 31.1 sq. metres (335.0 sq. feet)

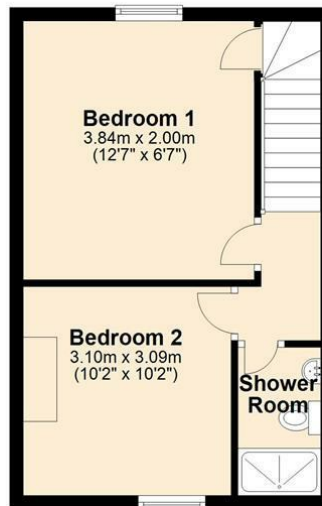

Total area: approx. 74.9 sq. metres (806.0 sq. feet)

These Plans are for Identification and Reference Only.
Plan produced using PlanUp.

18 Guildford Street, Hereford

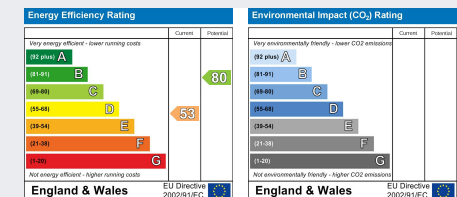

jackson
property

Address: 45 Bridge Street
Hereford
HR4 9DG

Tel: 01432 344 779
Email: hereford@bill-jackson.com
Web: www.bill-jackson.com

JACKSON PROPERTY for themselves and the vendors of the property, whose agents they are, give notice that these particulars, although believed to be correct, do not constitute any part of an offer of contract, that all statements contained in these particulars as to this property are made without responsibility and are not to be relied upon as statements or representations of fact and that they do not make or give any representation or warranty whatsoever in relation to this property. Any intending purchaser must satisfy himself by inspection or otherwise as to the correctness of each of the statements contained in these particulars.

