



exceptional service as standard.

01494 939868

hello@kingshills.co.uk

kingshills.co.uk



Micklefield Road | High Wycombe | HP13 7HB

Asking Price Of | £220,000

## Property Description

Ideal investment with tenants in situ paying £1000pcm. A modern and spacious 2-bedroom apartment located to the east side of High Wycombe. Further benefits from residents parking and a private balcony. The accommodation offers; spacious entrance hallway; lounge; kitchen; 2 double bedrooms and bathroom.

### TENURE

Leasehold

### COUNCIL TAX

Band C

### EPC RATING

C

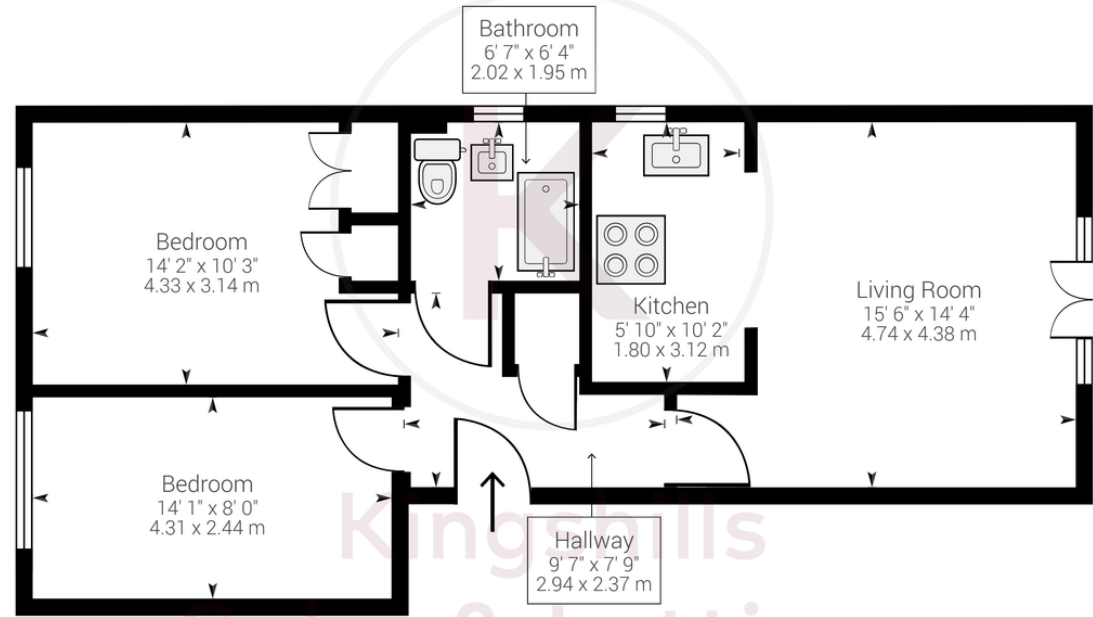

Approximate net internal area: 620.49 ft<sup>2</sup> / 57.65 m<sup>2</sup>

While every attempt has been made to ensure accuracy, all measurements are approximate, not to scale. This floor plan is for illustrative purpose only and should be used as such by any prospective tenant or purchaser.

Powered by Giraffe360

Aston Court  
Kingsmead Business Park  
High Wycombe  
Buckinghamshire  
HP11 1JU

01494 939868  
hello@kingshills.co.uk  
kingshills.co.uk

Agents Note: Whilst every care has been taken to prepare these particulars, they are for guidance purposes only. All measurements are for general guidance purposes only and whilst every care has been taken to ensure accuracy, they should not be relied upon and potential buyers/tenants are advised to recheck the measurements