

## Property Features

---

- Stunning Detached Family Home
- 4 Good sized Bedrooms
- Master with Dressing area and Ensuite
- Recently Refitted Kitchen/Breakfast Room
- 3 further Reception Rooms
- Utility Room and Downstairs Cloakroom
- Stunning Gardens with Seating area and Tranquil Pond
- Driveway Parking and Garage for Storage.
- Catchment of Highly Regarded Schools
- EPC: C

## Full Description

---

An absolutely stunning detached family home located in a quiet tucked away location in the popular South Buckinghamshire village of Penn. The property is within catchment of the highly regarded Tylers Green first and Middle school and also has great access to the M40.

### Accommodation

Inviting Entrance Hall, recently refitted Kitchen/Breakfast Room, Living Room with Fireplace, Family Room with doors leading to the rear garden, Dining Room, Utility room and Downstairs Cloakroom, 4 Bedrooms to the first floor with Mast benefitting a Dressing area and Ensuite Bathroom, Further Family Bathroom.

### Outside

The rear garden is a particular fine feature of the property which is all enclosed by mature hedging and fencing for a high degree of privacy and security. The lawn area stretches to the rear and side of the home and also has a lovely Decking/Seating area. To the front of the property there is a shingle Driveway ideal

for parking and to Half Garages that is now ideal for storage.

### Location

Situated just 10 minutes' drive from Beaconsfield, Penn is consistently popular with commuting couples and families, but this beautiful village offers far more than just convenience. Penn is renowned locally as a village of prestige properties, great primary schools and traditional village pubs and woodland. Providing that idyllic Chiltern village lifestyle, but within a short drive of High Wycombe with its wide range of shops and amenities. The area also offers superb walks through open countryside and designated ancient woodland.









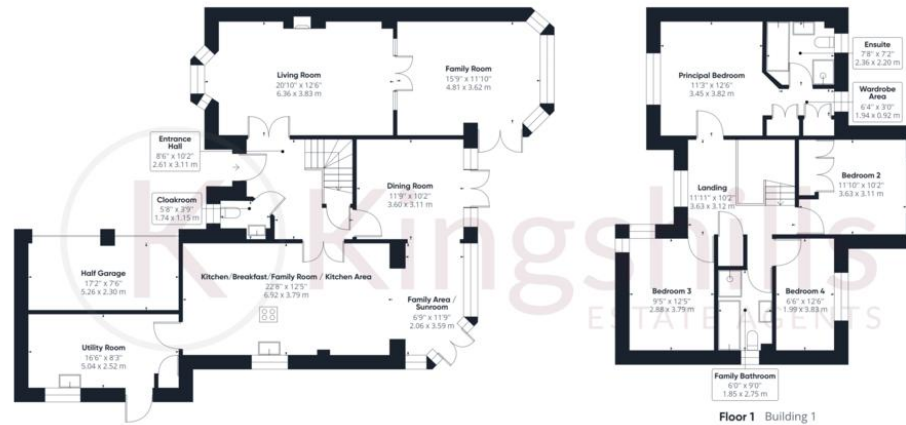

Ground Floor Building 1

Floor 1 Building 1

Approximate total area<sup>(1)</sup>  
2087.00 ft<sup>2</sup>  
193.89 m<sup>2</sup>

(1) Excluding balconies and terraces

While every attempt has been made to ensure accuracy, all measurements are approximate, not to scale. This floor plan is for illustrative purposes only.

GIRAFFE 360