



exceptional service as standard.

01494 939868

lettings@kingshills.co.uk

kingshills.co.uk



West Wycombe Road | High Wycombe | HP12 3AB

£725 pcm

## Property Description

A one-bedroom apartment located to the west side of High Wycombe, conveniently located close to amenities and a short walk into the town centre. The apartment has been well maintained and offers a modern kitchen and bathroom. Internally, the accommodation comprises; entrance hallway, double bedroom, open plan kitchen/living area and bathroom. Further benefits from parking to the rear of the development. Available unfurnished from early December.

COUNCIL TAX

Band B

EPC RATING

C

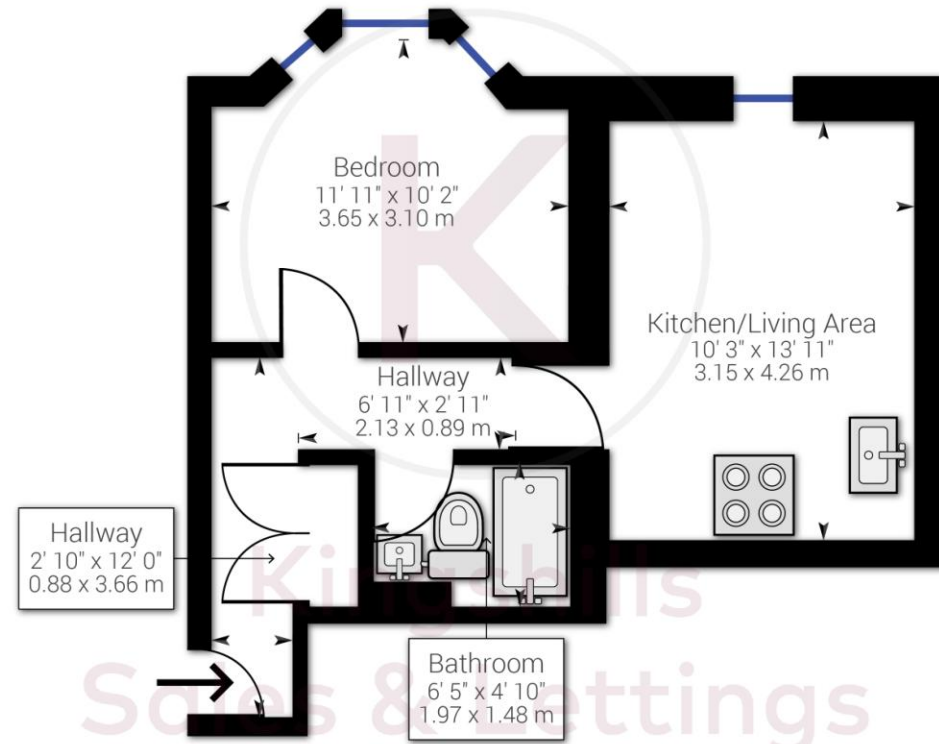

Approximate net internal area: 363.34 ft<sup>2</sup> / 33.76 m<sup>2</sup>

While every attempt has been made to ensure accuracy, all measurements are approximate, not to scale. This floor plan is for illustrative purpose only and should be used as such by any prospective tenant or purchaser.

Powered by Giraffe360

Aston Court  
Kingsmead Business Park  
High Wycombe  
Buckinghamshire  
HP11 1JU

01494 939868  
lettings@kingshills.co.uk  
kingshills.co.uk

Agents Note: Whilst every care has been taken to prepare these particulars, they are for guidance purposes only. All measurements are for general guidance purposes only and whilst every care has been taken to ensure accuracy, they should not be relied upon and potential buyers/tenants are advised to recheck the measurements