



Kingcup Close, Bromsgrove
Offers in the Region of £215,000

Features:

- Modern 3 bedroom semi-detached house
- Lounge/diner
- Kitchen area
- 2 double bedrooms
- Bathroom & guest W.C.
- Off-road parking for 2 cars
- Enclosed rear garden
- EPC rating - B

Description:

Completed by Bovis in 2015, being part of the Church Meadows development in Catshill. This modern semi-detached property is attractively sited opposite a spacious green, providing a play area, an abundance of mature trees and views across a fresh water pond and bridge. The property briefly comprises: porch, guest W.C., leading to the open plan ground floor comprising a modern fitted kitchen with integrated oven, hob, fridge/freezer, dishwasher, and space for a washing machine, a dining area, and on to the lounge having generous storage built-in, and french doors leading to the rear garden. Upstairs presents 3 bedrooms, 2 double and a single, offering home office space, a modern bathroom with shower over the bath, and airing cupboard. Outside to the side is parking for two cars whilst to the rear is the enclosed garden featuring an artificial lawn, decking area, and garden shed. Accessible for a range of local shops, eating establishments, and community facilities, as well as schools and a park, the property is also ideally located for commuting to the M42/M5 motorway junctions.



Details:

Porch

W.C.

Lounge/Diner

14' 8" max x 14' 7" max (4.47m x 4.44m)

Kitchen Area

10' 1" x 7' 0" (3.07m x 2.13m)

Stairs rise to first floor

Bedroom 1

14' 6" x 8' 2" (4.42m x 2.49m)

Bedroom 2

10' 11" x 8' 2" (3.32m x 2.49m)

Bedroom 3

9' 0" x 6' 3" (2.74m x 1.90m)

Bathroom

6' 9" x 6' 3" (2.06m x 1.90m)

EPC Rating: B

Council Tax Band: C (tbc by solicitors).

Tenure: (tbc by solicitors).

For more information or to arrange a viewing, please call us on 01527 910 300.



How can we help you?

Need a mortgage?

We recommend Morgan Financial Solutions. They will search the market for you to ensure you get the right lender and mortgage deal. They typically achieve mortgage offers much more quickly than if you were dealing with lenders directly. The initial appointment is free and without obligation. Call us on 01527 910 300, or visit their website for more information: www.morganfs.co.uk

Property to sell?

If you need to sell a property in order to buy, you ideally need to be on the market at least (and preferably Sold STC) before viewing, otherwise you may lose out to other buyers when the right property comes along. In these circumstances we can get your property 'live' quickly. Just book a free valuation and we will visit your property and discuss your needs.

Need a solicitor?

A good solicitor can save you literally weeks of time in the buying/selling process, reducing the stress levels of all involved. We will instruct a reputable firm that is competitive on cost and very reliable. Just ask for a quote.

Need a removal company and storage?

A professional removal company takes the stress out of moving. Knowing that your belongings are safe and insured far outweighs any small savings by trying to do it yourself or using a man-and-a-van service. We work closely with and recommend Cube Removals as the leading local firm. For peace of mind and a reliable service call them on 0800 193 0000 or visit their website, cuberemovals.co.uk, to arrange a survey.

GROUND FLOOR
362 sq.ft. (33.7 sq.m.) approx.

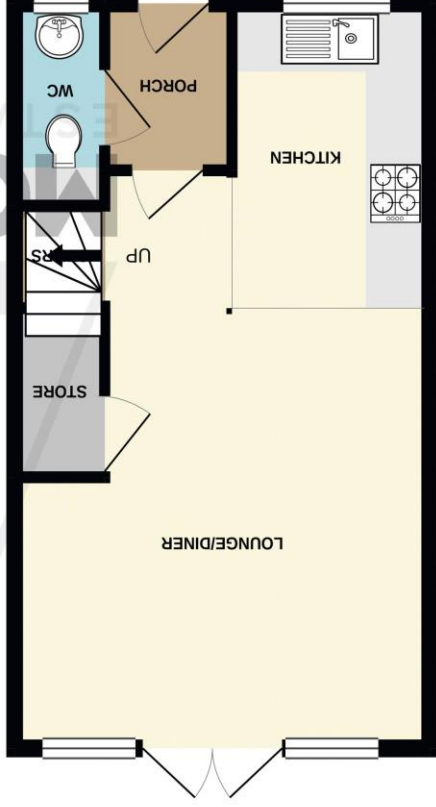

1ST FLOOR
362 sq.ft. (33.7 sq.m.) approx.

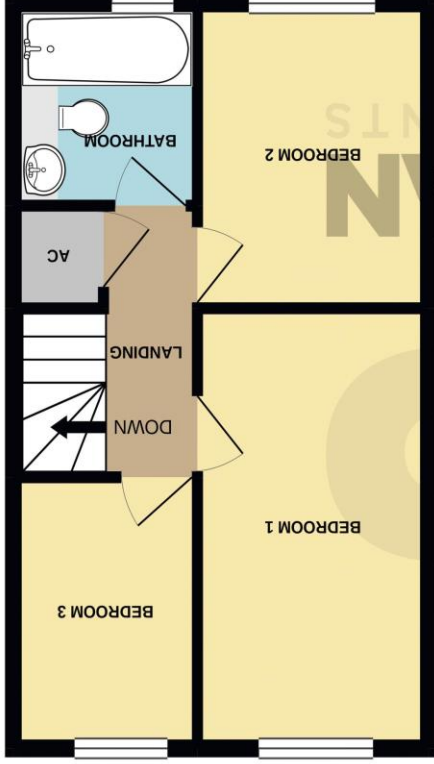

TOTAL FLOOR AREA : 725 sq.ft. (67.3 sq.m.) approx.

Whilst every attempt has been made to ensure the accuracy of the floorplan contained here, measurements of doors, windows, rooms and other items are approximate and no responsibility is taken for any error, omission or mis-statement. This plan is for illustrative purposes only and should be used as such by any prospective purchaser. The services, systems and appliances shown have not been tested and no guarantee as to their operability or efficiency can be given. Made with Metropix ©2020

No statement in these details is to be relied upon as representation of fact, and purchasers should satisfy themselves by inspection or otherwise as to the accuracy of the statements contained within. These details do not constitute any part of any offer or contract. AP Morgan and their employees and agents do not have any authority to give any warranty or representation whatsoever in respect of this property. These details and all statements herein are provided without any responsibility on the part of AP Morgan or the vendors. Equipment: AP Morgan has not tested the equipment or central heating system mentioned in these particulars and the purchasers are advised to satisfy themselves as to the working order and condition. Measurements: Great care is taken when measuring, but measurements should not be relied upon for ordering carpets, equipment, etc. The Laws of Copyright protect this material. AP Morgan is the Owner of the copyright. This property sheet forms part of our database and is protected by the database right and copyright laws. No unauthorised copying or distribution without permission.